

**WUNDA** 

Welcome to WundaSmart

## Welcome to your Smart Thermostat



The Scheduling Icon indicates the next temperature change will be set according to the schedule in the app.



The Manual Icon indicates the zone is in manual mode and will not change temperature until the next manual change, or it is switched back to the schedule.



The Lock Icon indicates the thermostat has been locked.



The Low Battery icon indicates it is time to change the battery. The remaining battery level of each battery powered device can be found in the app.



This Icon indicates the connection between the Thermostat and the Hub has been lost. Make sure your Hub is powered and the antenna is assembled.

## Operating Guide

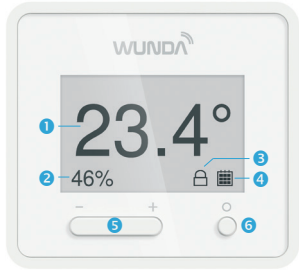

- 1 Current temperature
- 2 Room humidity
- 3 Thermostat Lock icon
- 4 Thermostat Operating Mode icon:  
☞ manual mode, 📅 scheduling mode
- 5 Temperature Setting buttons

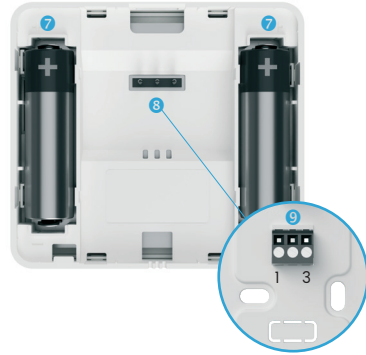

- 6 Switch to 'set to' screen and pairing button
- 7 2 x AA Alkaline Battery
- 8 Terminal for attaching an underfloor heating floor sensor
- 9 Connector 1 & 3 for external Under Floor Heating Sensor

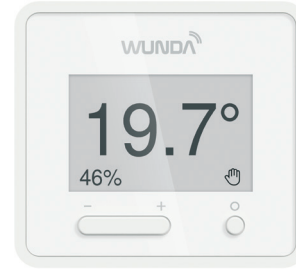

### Main Screen

Shows Current Temperature, Humidity and Operating Mode

- To switch between 'Main Screen' and 'Set to' Screen, press **O** once.
- To change the temperature, press **O** once to switch to the 'Set to' Screen. Then use the **+** and **-** to change the desired set temperature.



### 'Set to' Screen

Shows Desired Temperature and Operating Mode

- To lock and unlock the thermostat, press **O** to enter the 'Set to' screen. Then press **+** and **O** for 20 seconds.
- To switch between Scheduling and Manual Mode, press **O** to enter the 'Set to' screen. Then press **-** and **O** together.

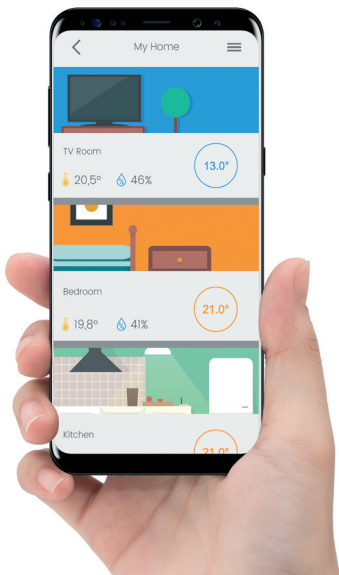
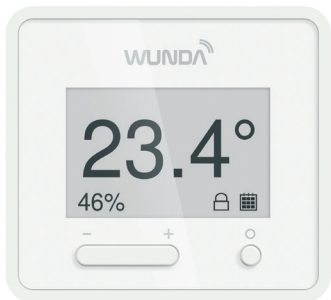

### Quick install guide

- A. Put the Batteries into their compartment, or remove the Tabs.
- B. Launch your **App** and choose the room where you want to add your Smart Thermostat.
- C. Press **Add device** and choose **Square Thermostat** from the list. Then press and hold **O** (button **6**) to pair your Smart Thermostat.

For more information please visit:  
[www.wundasmart.com/support](http://www.wundasmart.com/support)

### Need our help?

Our designated support staff are on hand to answer all your questions

 [help@wundasmart.com](mailto:help@wundasmart.com)

 0800 083 2677